

purple surgical

# The *Ultimate* Surgical Stapling Range



FROM THE UK'S LEADING MANUFACTURER OF LAPAROSCOPIC INSTRUMENTS AND DEVICES

# The *Ultimate Reloadable* Linear Cutter Stapler

A new blade with each Reloading Unit guarantees smooth, precise transection with each firing, reducing the risk of cross infection.

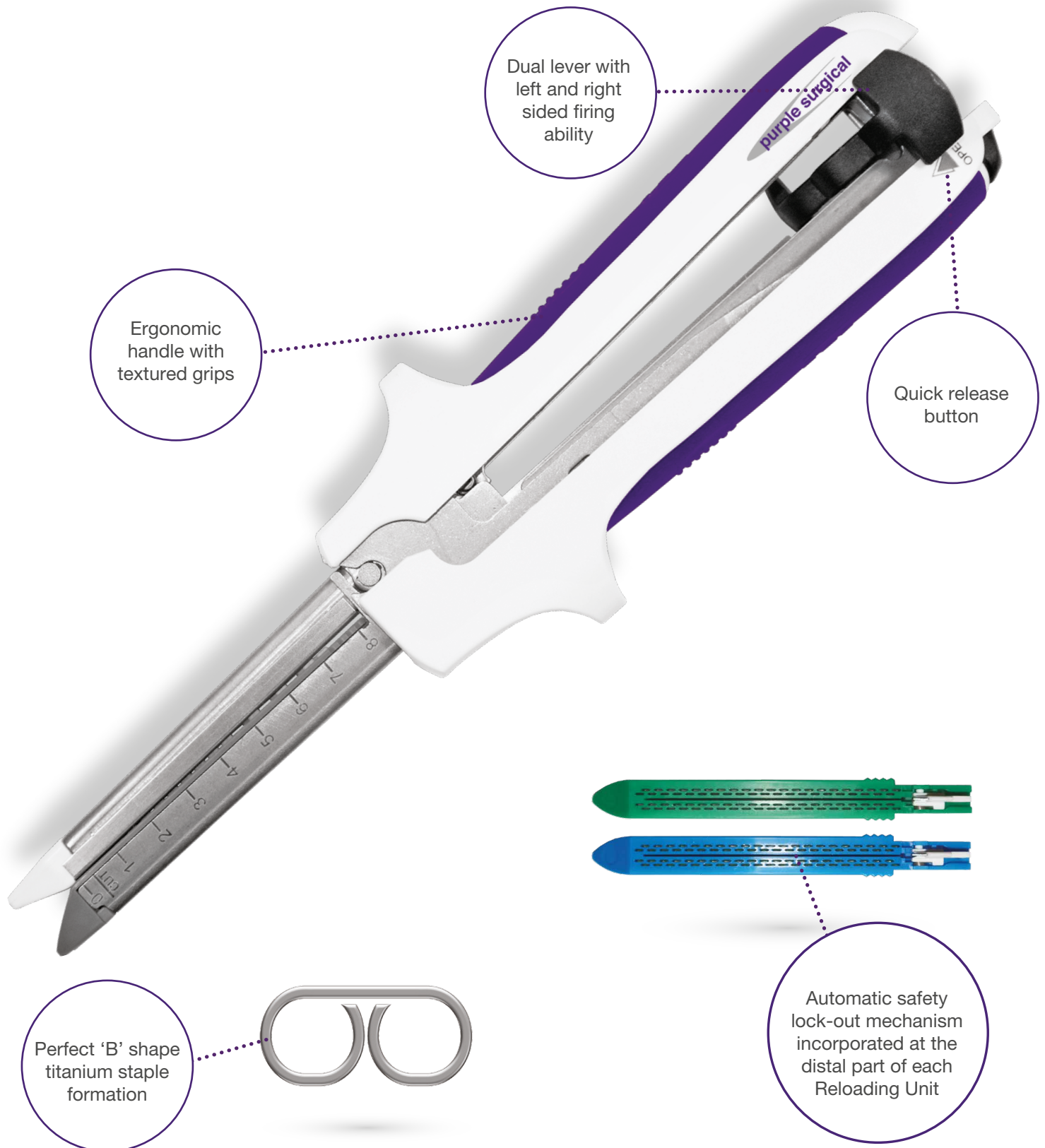

The Purple Surgical **Ultimate** Reloadable Linear Cutter Stapler places two double staggered rows of titanium staples and simultaneously cuts and divides tissue between the two double rows.

**Anatomy suitable for this device includes:**

**General Surgery** - Stomach | Small Intestine | Pancreas | Colon

**Urologic Surgery** - Ileal Conduit

**Thoracic Surgery** - Parenchyma, Main and Lobar Bronchi

**Why choose the *Ultimate* Reloadable Linear Cutter Stapler:**

- + New blade with each reloading unit guarantees smooth, precise transection with each firing and reduces the risk of cross infection
- + Staple formation creates the perfect 'B' shaped staple on every firing for improved clinical performance and safe haemostasis
- + Ergonomic design with textured grip inlays facilitates user comfort and control
- + Adjustable bidirectional firing lever enables firing from either side of the device
- + Quick release button and rear hinge enables single handed operation

The device is available in 60mm, 80mm and 100mm staple lengths. Reloading Units are available for both standard tissue (3.8mm) and thick tissue (4.8mm)

## The **Ultimate** Reloadable Linear Cutter Stapler

PRODUCT	CODE	COLOUR	TISSUE TYPE	OPEN STAPLE HEIGHT	CLOSED STAPLE HEIGHT	QTY
<b>Ultimate</b> 60mm Reloadable Linear Cutter Stapler	PS9LC60B	Blue	Standard	3.8mm	1.5mm	3 / Box
<b>Ultimate</b> 60mm Reloadable Linear Cutter Stapler	PS9LC60G	Green	Thick	4.8mm	2.0mm	3 / Box
<b>Ultimate</b> 80mm Reloadable Linear Cutter Stapler	PS9LC80B	Blue	Standard	3.8mm	1.5mm	3 / Box
<b>Ultimate</b> 80mm Reloadable Linear Cutter Stapler	PS9LC80G	Green	Thick	4.8mm	2.0mm	3 / Box
<b>Ultimate</b> 100mm Reloadable Linear Cutter Stapler	PS9LC100B	Blue	Standard	3.8mm	1.5mm	3 / Box
<b>Ultimate</b> 100mm Reloadable Linear Cutter Stapler	PS9LC100G	Green	Thick	4.8mm	2.0mm	3 / Box

## The **Ultimate** Linear Cutter Stapler Reloading Units

PRODUCT	CODE	COLOUR	TISSUE TYPE	OPEN STAPLE HEIGHT	CLOSED STAPLE HEIGHT	QTY
<b>Ultimate</b> 60mm Reloadable Linear Cutter Stapler	PS9LCR60B	Blue	Standard	3.8mm	1.5mm	12 / Box
<b>Ultimate</b> 60mm Reloadable Linear Cutter Stapler	PS9LCR60G	Green	Thick	4.8mm	2.0mm	12 / Box
<b>Ultimate</b> 80mm Reloadable Linear Cutter Stapler	PS9LCR80B	Blue	Standard	3.8mm	1.5mm	12 / Box
<b>Ultimate</b> 80mm Reloadable Linear Cutter Stapler	PS9LCR80G	Green	Thick	4.8mm	2.0mm	12 / Box
<b>Ultimate</b> 100mm Reloadable Linear Cutter Stapler	PS9LCR100B	Blue	Standard	3.8mm	1.5mm	12 / Box
<b>Ultimate</b> 100mm Reloadable Linear Cutter Stapler	PS9LCR100G	Green	Thick	4.8mm	2.0mm	12 / Box

# The *Ultimate Reloadable Linear Stapler with Indicator*

Colour-coded indication window allows for simple prevention of mis-firing

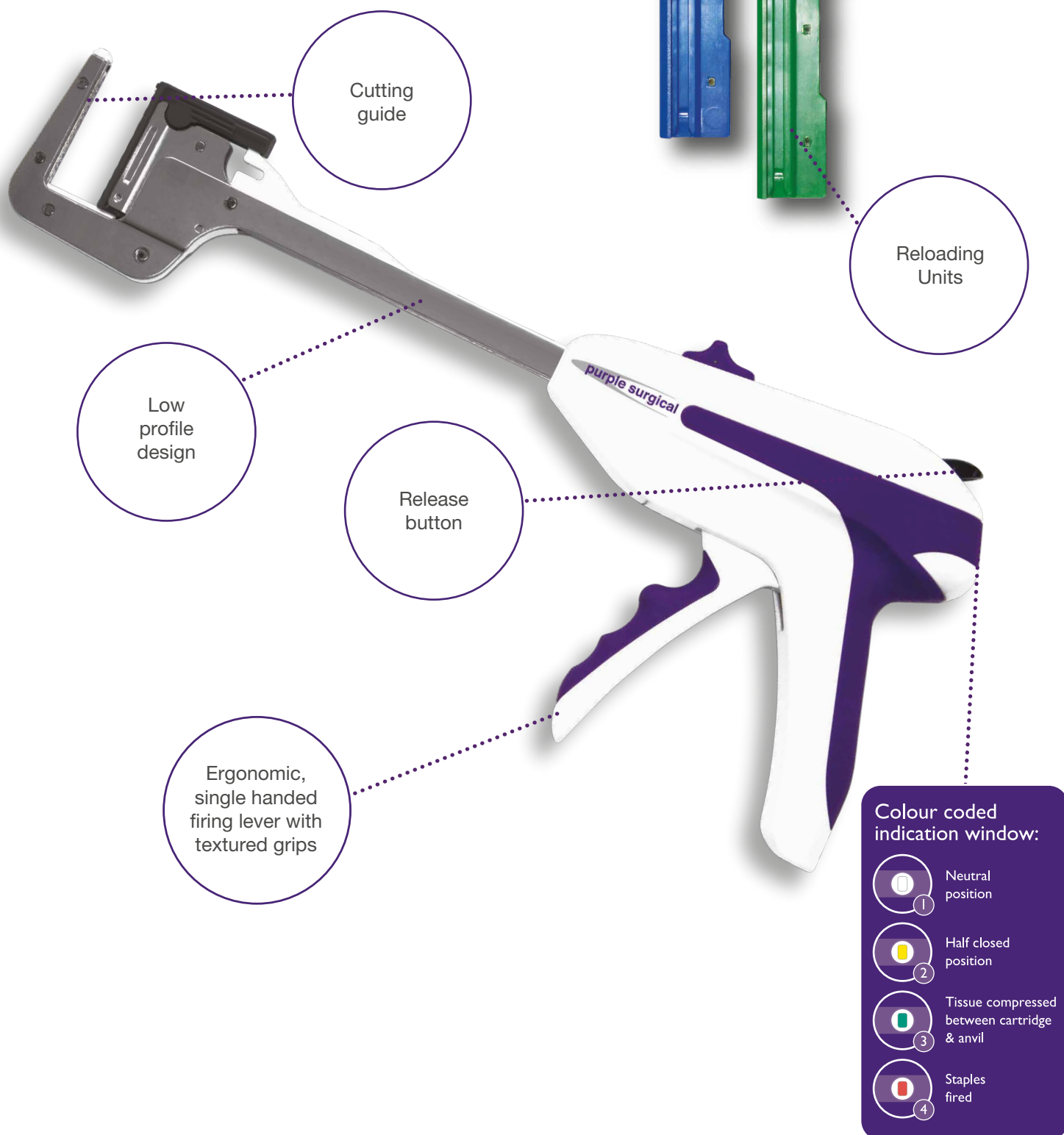



The Purple Surgical **Ultimate** Reloadable Linear Stapler with Indicator places two staggered rows of titanium staples that create the perfect 'B' shaped staple formation on each and every firing for improved clinical performance.

Anatomy suitable for this device includes:

**General Surgery** - Oesophagus | Stomach | Small Intestine | Colon | Pylorus

**Thoracic Surgery** - Parenchyma | Bronchus

Why choose the **Ultimate** Reloadable Linear Stapler with Indicator:

- + Colour-coded indication window allows for simple prevention of mis-firing
- + The ergonomic design with textured grip and single-handed firing lever, facilitates user comfort and control
- + Low profile design for easy access
- + Retaining pin can either be manually or mechanically engaged
- + Cutting guide enhances safety during transection

The device is available in 4 size options: 30mm, 45mm, 60mm and 90mm staple line lengths. Reloading Units are available for both standard tissue (3.5mm) and thick tissue (4.8mm)

## The **Ultimate** Reloadable Linear Stapler with Indicator

PRODUCT	CODE	COLOUR	TISSUE TYPE	OPEN STAPLE HEIGHT	CLOSED STAPLE HEIGHT	QTY
<b>Ultimate</b> 30mm Reloadable Linear Stapler with Indicator	PS9LSI30B	Blue	Standard	3.5mm	1.5mm	3 / Box
<b>Ultimate</b> 30mm Reloadable Linear Stapler with Indicator	PS9LSI30G	Green	Thick	4.8mm	2.0mm	3 / Box
<b>Ultimate</b> 45mm Reloadable Linear Stapler with Indicator	PS9LSI45B	Blue	Standard	3.5mm	1.5mm	3 / Box
<b>Ultimate</b> 45mm Reloadable Linear Stapler with Indicator	PS9LSI45G	Green	Thick	4.8mm	2.0mm	3 / Box
<b>Ultimate</b> 60mm Reloadable Linear Stapler with Indicator	PS9LSI60B	Blue	Standard	3.5mm	1.5mm	3 / Box
<b>Ultimate</b> 60mm Reloadable Linear Stapler with Indicator	PS9LSI60G	Green	Thick	4.8mm	2.0mm	3 / Box
<b>Ultimate</b> 90mm Reloadable Linear Stapler with Indicator	PS9LSI90B	Blue	Standard	3.5mm	1.5mm	3 / Box
<b>Ultimate</b> 90mm Reloadable Linear Stapler with Indicator	PS9LSI90G	Green	Thick	4.8mm	2.0mm	3 / Box

## The **Ultimate** Linear Stapler Reloading Units

PRODUCT	CODE	COLOUR	TISSUE TYPE	OPEN STAPLE HEIGHT	CLOSED STAPLE HEIGHT	QTY
<b>Ultimate</b> 30mm Linear Stapler Reloading Unit	PS9LSR30B	Blue	Standard	3.5mm	1.5mm	12 / Box
<b>Ultimate</b> 30mm Linear Stapler Reloading Unit	PS9LSR30G	Green	Thick	4.8mm	2.0mm	12 / Box
<b>Ultimate</b> 45mm Linear Stapler Reloading Unit	PS9LSR45B	Blue	Standard	3.5mm	1.5mm	12 / Box
<b>Ultimate</b> 45mm Linear Stapler Reloading Unit	PS9LSR45G	Green	Thick	4.8mm	2.0mm	12 / Box
<b>Ultimate</b> 60mm Linear Stapler Reloading Unit	PS9LSR60B	Blue	Standard	3.5mm	1.5mm	12 / Box
<b>Ultimate</b> 60mm Linear Stapler Reloading Unit	PS9LSR60G	Green	Thick	4.8mm	2.0mm	12 / Box
<b>Ultimate</b> 90mm Linear Stapler Reloading Unit	PS9LSR90B	Blue	Standard	3.5mm	1.5mm	12 / Box
<b>Ultimate</b> 90mm Linear Stapler Reloading Unit	PS9LSR90G	Green	Thick	4.8mm	2.0mm	12 / Box

# *The Ultimate Circular Stapler with Dual Safety*

Teflon cutting washer allows for audible and tactile feedback



The Purple Surgical **Ultimate** Circular Stapler with Dual Safety places a circular staggered double row of titanium staples and resects excess tissue to create a circular anastomosis.

Anatomy suitable for this device includes:

**General Surgery** - Oesophagus | Stomach | Small Intestine | Colon | Rectum

**Why choose the *Ultimate* Circular Stapler with Dual Safety:**

- + Teflon cutting washer allows for audible and tactile feedback
- + Staple formation creates the perfect 'B' shape staple when the red line is positioned centrally within the green firing indicator window
- + The ergonomic design and textured firing handle facilitates user comfort and control
- + Dual safety lock-out mechanism prevents misfiring
- + Fin shaped wing nut for easy counting of full or half turns

The device is available in 5 size options identified by colour coded anvil washers. 3 open staple heights and variable closed staple heights are available for optimal tissue thickness matching

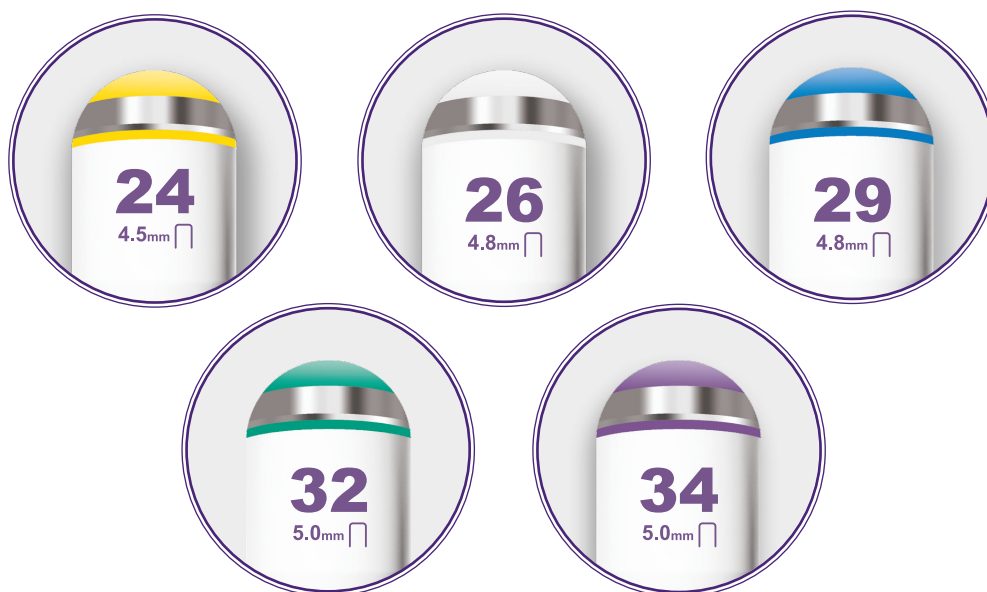

## The **Ultimate** Circular Stapler with Dual Safety

PRODUCT	CODE	COLOUR	LUMEN	SHAFT LENGTH	OPEN STAPLE HEIGHT	CLOSED STAPLE HEIGHT	QTY
<b>Ultimate</b> 24mm Circular Stapler with Dual Safety	PS9CS24S	Yellow	15mm	18.5cm	4.5mm	1.8mm	3 / Box
<b>Ultimate</b> 26mm Circular Stapler with Dual Safety	PS9CS26S	White	17mm	18.5cm	4.8mm	2.0mm	3 / Box
<b>Ultimate</b> 29mm Circular Stapler with Dual Safety	PS9CS29S	Blue	20mm	18.5cm	4.8mm	2.0mm	3 / Box
<b>Ultimate</b> 32mm Circular Stapler with Dual Safety	PS9CS32S	Green	24mm	18.5cm	5.0mm	2.2mm	3 / Box
<b>Ultimate</b> 34mm Circular Stapler with Dual Safety	PS9CS34S	Purple	24.5mm	18.5cm	5.0mm	2.2mm	3 / Box

# *The Ultimate Circular Stapler with Dual Safety & Tilt Top Anvil*

The vented, low profile Tilt Top Anvil releases vacuum and minimises the potential of tissue trauma on removal.

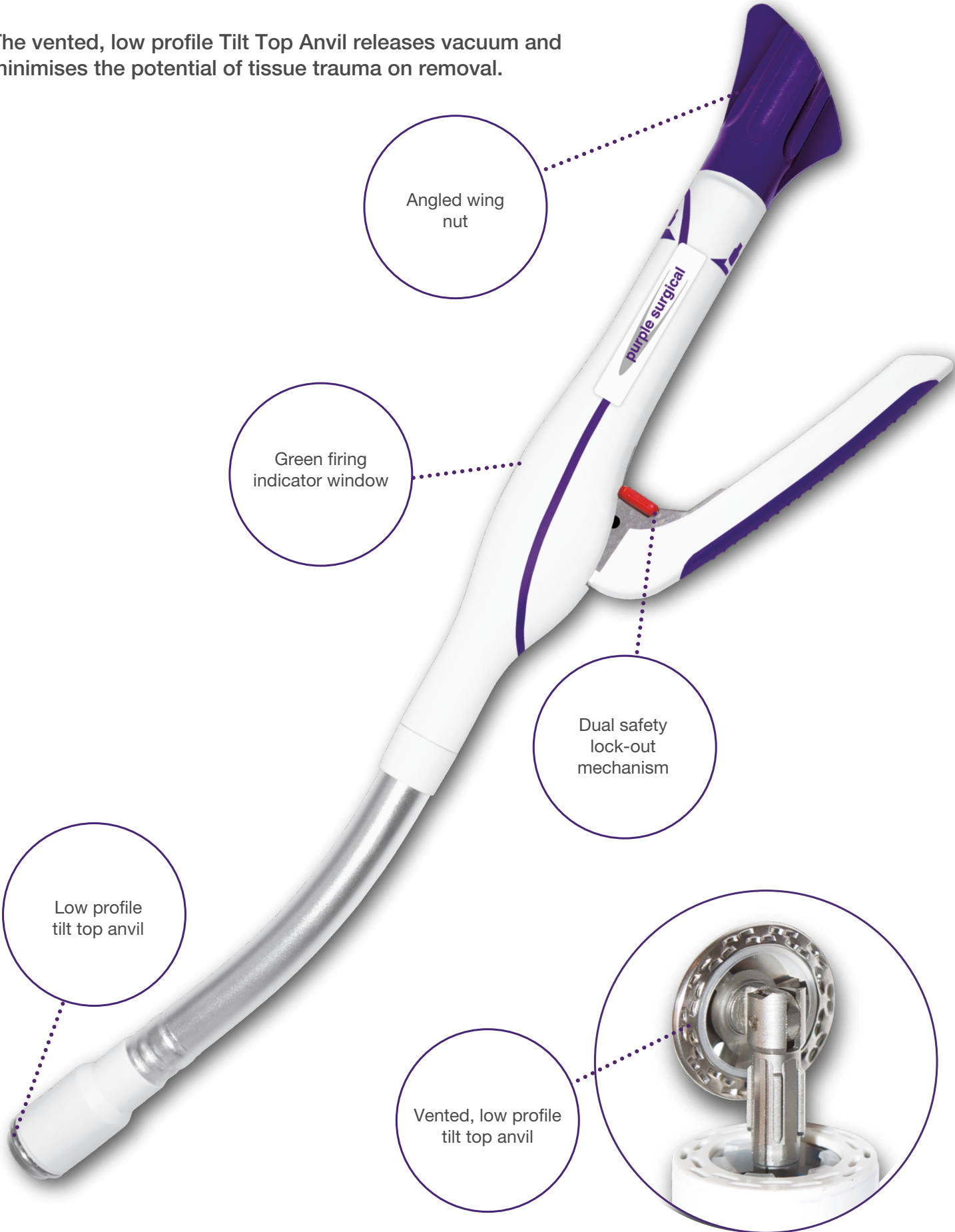



The Purple Surgical **Ultimate** Circular Stapler with Dual Safety & Tilt Top Anvil places a circular staggered, double row of titanium staples in the tissue and resects excess tissue to create a circular anastomosis.

Anatomy suitable for this device includes:

**General Surgery** - Oesophagus | Stomach | Duodenum | Colon | Rectum

**Why choose the *Ultimate* Circular Stapler with Dual Safety & Tilt Top Anvil:**

- + Teflon cutting washer allows for audible and tactile feedback
- + Vented, low profile tilt top anvil releases vacuum and minimises the potential of tissue trauma on insertion and removal
- + Staple formation creates the perfect 'B' shaped staple when the red line is positioned centrally within the green firing indicator window
- + The ergonomic design and textured firing handle facilitates user comfort and control
- + Dual safety lock-out mechanism prevents misfiring
- + Angled wing nut allows for easy counting of full and half turns

The device is available in 4 sizes, identified by colour-coded anvil washers, with 3 staple sizes available to provide optimal tissue thickness matching.



The **Ultimate** Circular Stapler with Dual Safety & Tilt Top Anvil

PRODUCT	CODE	COLOUR	LUMEN	SHAFT LENGTH	OPEN STAPLE HEIGHT	CLOSED STAPLE HEIGHT	QTY
<b>Ultimate</b> 24mm Circular Stapler with Dual Safety & Tilt Top Anvil	PS9CSA24S	Yellow	15mm	18.5cm	4.5mm	1.8mm	3 / Box
<b>Ultimate</b> 26mm Circular Stapler with Dual Safety & Tilt Top Anvil	PS9CSA26S	White	17mm	18.5cm	4.8mm	2.0mm	3 / Box
<b>Ultimate</b> 29mm Circular Stapler with Dual Safety & Tilt Top Anvil	PS9CSA29S	Blue	20mm	18.5cm	4.8mm	2.0mm	3 / Box
<b>Ultimate</b> 32mm Circular Stapler with Dual Safety & Tilt Top Anvil	PS9CSA32S	Green	24mm	18.5cm	5.0mm	2.2mm	3 / Box

# *The Ultimate Haemorrhoidal Circular Stapler with Dual Safety & Transparent Cartridge*

The transparent cartridge gives direct visualisation of the tissue within.



The Purple Surgical **Ultimate** Haemorrhoidal Circular Stapler with Dual Safety & Transparent Cartridge places a circular staggered, double row of titanium staples in the tissue and resects excess tissue.

The device is designed for use in the surgical treatment of haemorrhoidal disease.

Staple formation creates the perfect 'B' shaped staple when the red line is positioned centrally within the green firing indicator window. Fixed anvil eliminates the risk of detachment from the cartridge.

#### Why choose the **Ultimate** Haemorrhoidal Circular Stapler:

- + Transparent cartridge for direct visualisation of the tissue
- + Fixed anvil eliminates the risk of detachment from the cartridge
- + 4 suture threading ports for even selection of prolapsed mucosa
- + Dual safety lock-out mechanism prevents misfiring
- + Incremental markings to clearly measure distance from the dentate line

The device is available in two size options; 32/33mm and 33/34mm and supplied with 5 accessories



Clear Circular  
Anal Dilator



Clear Butterfly  
Anal Dilator

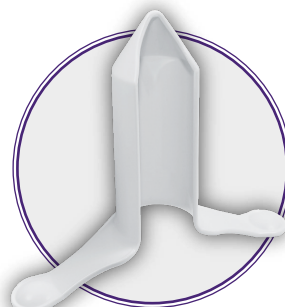

Purse-string  
Suture Anoscope



Anal Dilator  
Obturator

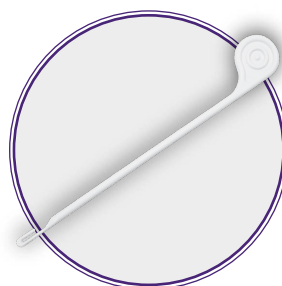

Suture  
Threader

#### The **Ultimate** Haemorrhoidal Circular Stapler with Dual Safety & Transparent Cartridge

PRODUCT	CODE	KNIFE DIAMETER	OPEN STAPLE HEIGHT	CLOSED STAPLE HEIGHT	QTY
<b>Ultimate</b> 32/33mm Haemorrhoidal Circular Stapler	PS9HCS32/33	22cm	3.8mm	1.5mm	3 / Box
<b>Ultimate</b> 33/34mm Haemorrhoidal Circular Stapler	PS9HCS33/34	24cm	3.8mm	1.5mm	3 / Box

# The *Ultimate Endoscopic Linear Cutter Staplers with universal handle*



SIZE OF RELOAD UNIT	NO. OF SQUEEZES REQUIRED
30mm	2
45mm	3
60mm	4

The Purple Surgical **Ultimate** Endoscopic Linear Cutter Stapler places two, triple-staggered rows of titanium staples and simultaneously cuts and divides the tissue between the two rows. The Universal Handle is available in 3 shaft lengths; 6cm, 16cm and 26cm accommodating 30mm, 45mm and 60mm articulating reloading units.

**Why choose the *Ultimate* Endoscopic Linear Cutter Stapler:**

- + Gentle tissue compression before firing minimises tissue trauma and supports repositioning
- + Cutting knife housed within the reloading unit guarantees an even distance between anvil and cartridge as it passes through the tissue for consistent, leak free staple formation
- + Cartridge lock-out safety mechanism prevents the reuse of fired reloading units
- + The Universal Handle is available in three size options and compatible with all Purple Surgical reloading units
- + The **Ultimate** Endoscopic Linear Cutter Stapler Universal Handle can be fired up to 25 times during a single procedure
- + The reloading units are available in the following sizes, for varying tissue thickness: White (2.5mm), Blue (3.5mm), Gold (4.2mm), Green (4.8mm), Black (5.0mm)
- + White, Blue and Gold reloading units are compatible with Purple Surgical's **Ultimate** 12mm Trocars
- + Green and Black reloading units fit through 15mm Trocars
- + Each reloading unit houses a sharp knife blade to ensure a precise cut with every firing
- + Staple gap control allows for consistent staple formation as the cutting knife proceeds through the transecting tissue
- + Suitable for: Bariatric Surgery, Colorectal Surgery, Gynaecological Surgery, Paediatric Surgery, Thoracic Surgery
- + Improved gripping technology to minimise longitudinal and lateral tissue spread

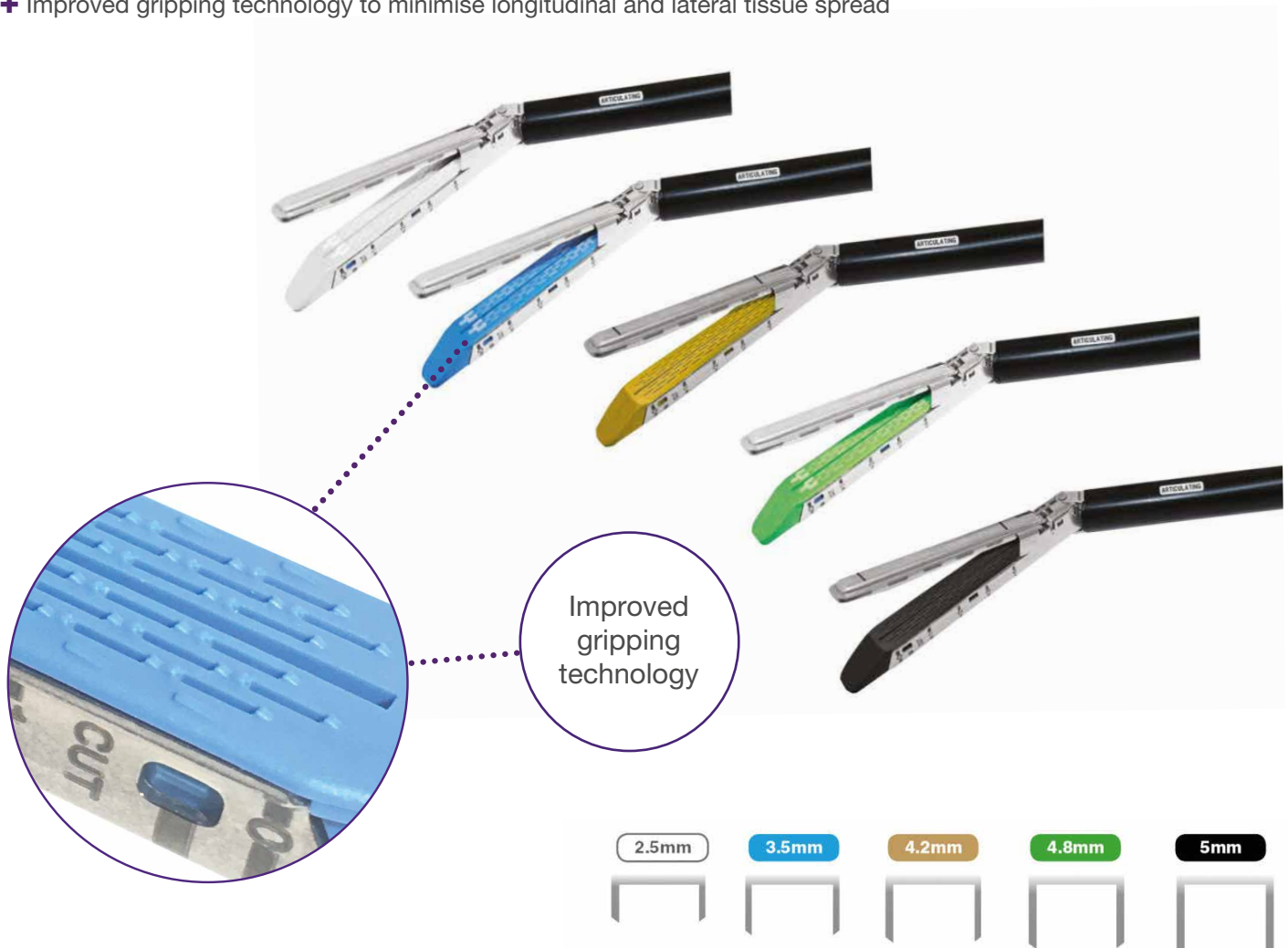



# Ordering Details

## The **Ultimate** Endoscopic Linear Cutter Staplers with Universal Handles

PRODUCT	CODE	SHAFT LENGTH	QTY
<b>Ultimate</b> Endoscopic Linear Cutter with Universal Handles	PS9ECHU06	60mm	3 / Box
<b>Ultimate</b> Endoscopic Linear Cutter with Universal Handles	PS9ECHU16	160mm	3 / Box
<b>Ultimate</b> Endoscopic Linear Cutter with Universal Handles	PS9ECHU26	260mm	3 / Box

## The **Ultimate** Endoscopic Linear Cutter Stapler **Articulating** Reloading Units

DESCRIPTION	CODE	COLOUR	TISSUE TYPE	CUT LENGTH	ROWS	STAPLES	OPEN STAPLE HEIGHT	CLOSED STAPLE HEIGHT	PACK QTY
<b>Ultimate</b> 30mm Endoscopic Articulating Reloading Unit	PS9ECAR30W	White	Thin	25mm	6	48	2.5mm	1.0mm	6 / Box
<b>Ultimate</b> 30mm Endoscopic Articulating Reloading Unit	PS9ECAR30B	Blue	Standard	25mm	6	48	3.5mm	1.5mm	6 / Box
<b>Ultimate</b> 45mm Endoscopic Articulating Reloading Unit	PS9ECAR45W	White	Thin	40mm	6	66	2.5mm	1.0mm	6 / Box
<b>Ultimate</b> 45mm Endoscopic Articulating Reloading Unit	PS9ECAR45B	Blue	Standard	40mm	6	66	3.5mm	1.5mm	6 / Box
<b>Ultimate</b> 45mm Endoscopic Articulating Reloading Unit	PS9ECAR45D	Gold	Regular -Thick	40mm	6	66	4.2mm	1.8mm	6 / Box
<b>Ultimate</b> 45mm Endoscopic Articulating Reloading Unit	PS9ECAR45G	Green	Thick	40mm	6	66	4.8mm	2.0mm	6 / Box
<b>Ultimate</b> 45mm Endoscopic Articulating Reloading Unit	PS9ECAR45N	Black	Very Thick	40mm	6	66	5.0mm	2.35mm	6 / Box
<b>Ultimate</b> 60mm Endoscopic Articulating Reloading Unit	PS9ECAR60W	White	Thin	55mm	6	90	2.5mm	1.0mm	6 / Box
<b>Ultimate</b> 60mm Endoscopic Articulating Reloading Unit	PS9ECAR60B	Blue	Standard	55mm	6	90	3.5mm	1.5mm	6 / Box
<b>Ultimate</b> 60mm Endoscopic Articulating Reloading Unit	PS9ECAR60D	Gold	Regular -Thick	55mm	6	90	4.2mm	1.8mm	6 / Box
<b>Ultimate</b> 60mm Endoscopic Articulating Reloading Unit	PS9ECAR60G	Green	Thick	55mm	6	90	4.8mm	2.0mm	6 / Box
<b>Ultimate</b> 60mm Endoscopic Articulating Reloading Unit	PS9ECAR60N	Black	Very Thick	55mm	6	90	5.0mm	2.35mm	6 / Box

# The *Ultimate* 10mm M/L Single-Use Clip Applier

**Ultimate** Quality  
**Ultimate** Performance  
**Incredible** Value

The Purple Surgical **Ultimate** Clip Applier has been designed to ensure maximum clip retention following ideal visualisation during approximation and smooth device activation.

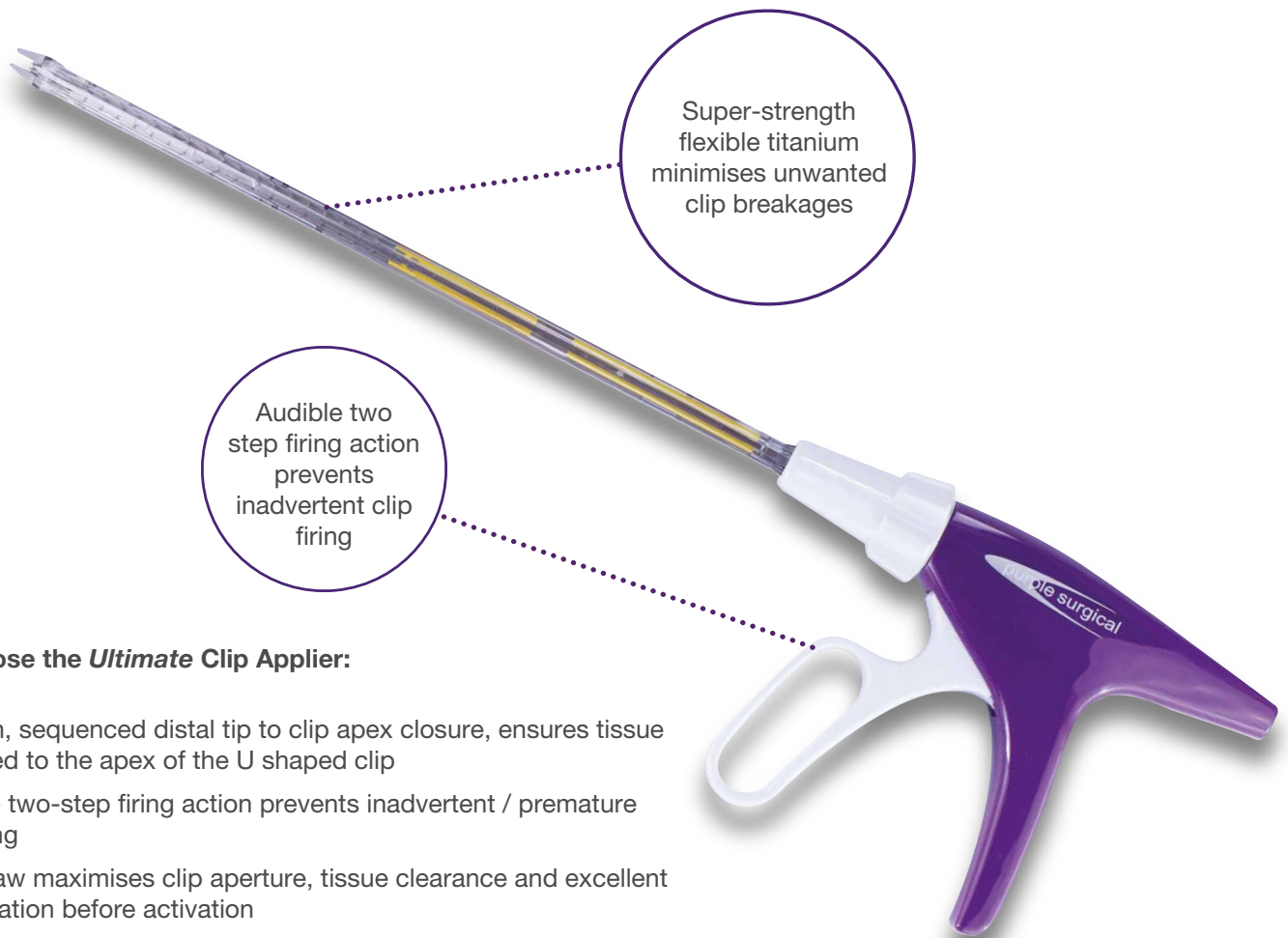

## Why choose the *Ultimate* Clip Applier:

- + Smooth, sequenced distal tip to clip apex closure, ensures tissue is guided to the apex of the U shaped clip
- + Audible two-step firing action prevents inadvertent / premature clip firing
- + Large jaw maximises clip aperture, tissue clearance and excellent visualisation before activation
- + Super-strength flexible titanium minimises unwanted clip breakages
- + Opposing axial and lateral clip grooves minimise tissue migration and maximise retention
- + Safety lock prevents empty jaw from inadvertently closing on tissue.

## The *Ultimate* 10mm M/L Single-Use Clip Applier

PRODUCT	CODE	PRODUCT DESCRIPTION	QTY
<b>Ultimate</b> 10mm M/L Single-Use Clip Applier	PS3585ULT	10mm x 33cm 20 M/L Titanium Clips	5 / Box

**Purple Surgical** is the leading independent British manufacturer of high quality, cost-effective single-use surgical instrumentation and devices, partnering with global healthcare providers for positive patient outcomes.

## Contact Us

Tel: +44 (0)1923 839333

Email: [mail@puplesurgical.com](mailto:mail@puplesurgical.com)

[www.puplesurgical.com](http://www.puplesurgical.com)



**Great British Manufacturing**

Purple Surgical UK Ltd

Purple Surgical International Ltd

2 Chestnut House, Farm Close, Shenley, Herts. WD7 9AD, England